

# THE BOX GUIDE

This guide gives you all the information you need for selecting the components and accessories for your kitchen. Please call 203.453.0546 if you have questions or need assistance with the order process.

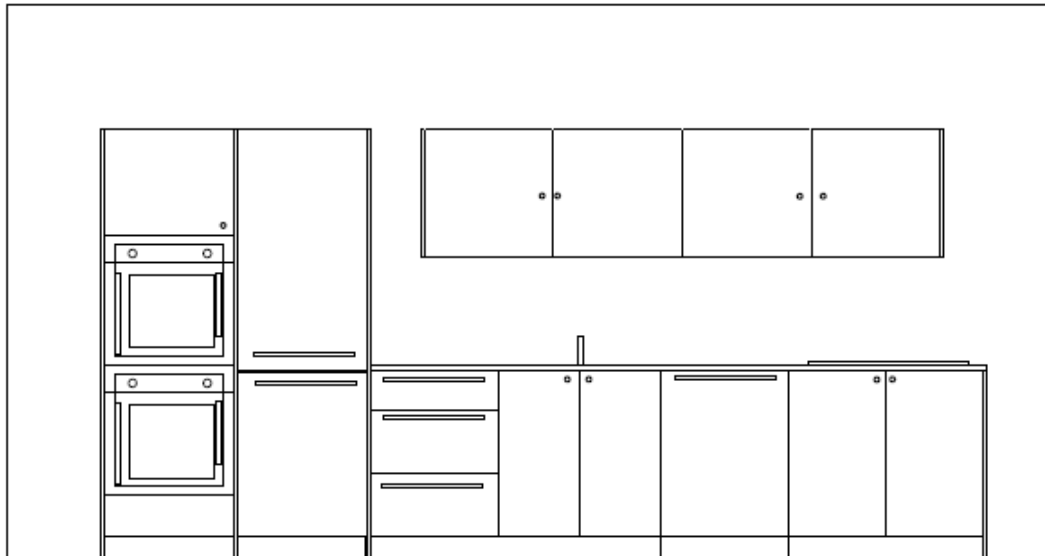

## Standard:

---

- 3 cabinet styles: toekick ; legs ; wall hung
- excellent craftsmanship
- 3/4" maple plywood construction
- flat overlay doors
- choice of stainless pulls
- full extension drawer glides
- soft closure; doors and drawers
- solid maple dovetail drawers
- appliance ready boxes
- laminate on exposed multiply
- wood veneer w/ matching edgebanding

## Optional:

---

- customization
- design consultation
- design/layout

# THE BOX GUIDE



## BOX GUIDE INDEX

---

page 3	.....	general information
page 4	.....	materials
page 5	.....	lower box
page 8	.....	pantry box
page 10	.....	upper box with inset doors
page 11	.....	upper box with overlay doors
page 12	.....	vertical upper box
page 13	.....	drawer boxes and pullout trays
page 13	.....	adjustable shelves
page 14	.....	applied end / side panels
page 14	.....	fillers / toekicks / misc
page 15	.....	accessories

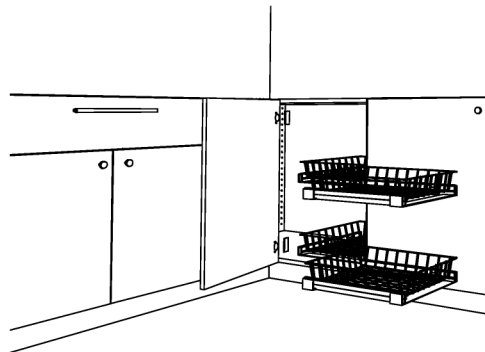
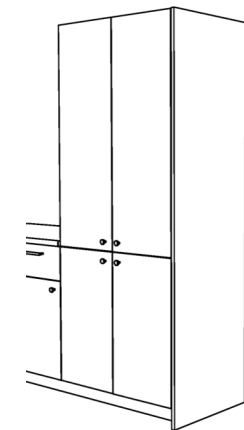
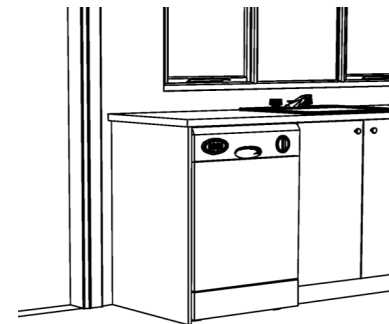
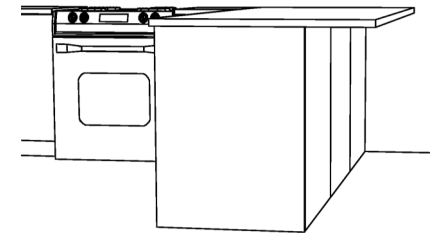

# THE BOX GUIDE



## GENERAL INFORMATION

**BOX KITCHEN** is manufactured in the US and shipped nation wide.

### **ordering:**

To inquire or place an order, please call our office @ 203.453.0546 or email us at [design@boxkitchen.com](mailto:design@boxkitchen.com)

### **shipping:**

Once an order is complete and a deposit is paid, your order will be shipped to you in approx 6-8 weeks. Shipping time varies 1-2 weeks, depending on your location. If changes are made after initial start date, shipping date may change.

### **delivery:**

Your boxes will arrive safely wrapped in cardboard boxes. Each cabinet box will be fully assembled: doors; drawers; trays; and panels will be assembled if weight allows. Otherwise they are easily attached in field. Some adjustment may be necessary by your installer or carpenter. NOTE: any kitchen installer and or contractor will know how to adjust the hinge and drawer hardware.

### **installation:**

All modular BOX components are designed to be installed with a minimum of effort. As long as a few important steps are followed, you will be assured of a perfect installation. We do provide a handy Installation Manual that we recommend reviewing with your kitchen installer and/or contractor.

### **samples:**

You can see color swatches of our laminates and wood veneers @ [www.boxkitchen.com](http://www.boxkitchen.com); or you may call for a sample ring.

### **help desk:**

You may call us for assistance @ 202.453.0546. 9am-5pm EST Mon-Fri

# THE BOX GUIDE



## MATERIALS

### laminates

- all laminates are mounted onto 3/4" multi-ply
- all laminate panel edges have clear finish
- panels with exposed edges will be edged with same laminate, unless noted otherwise
- 25 standard colors; satin and gloss finishes
- 8 premium finishes; metal, frosted and textured

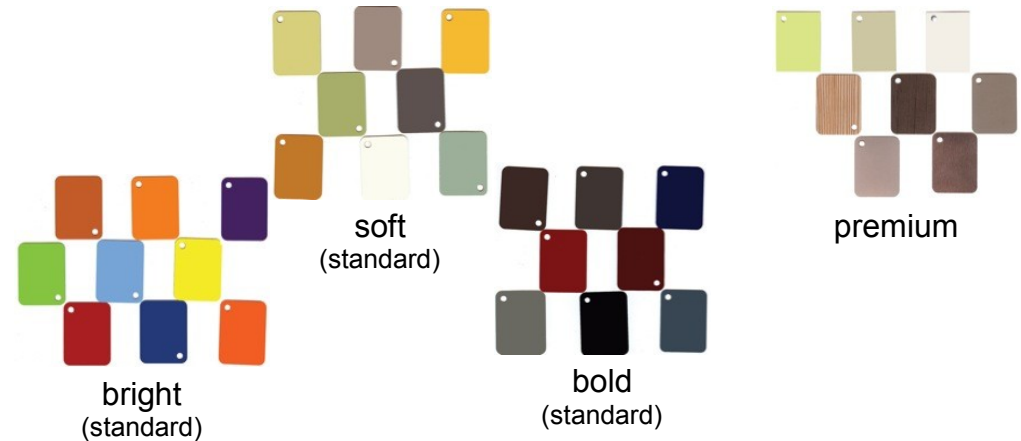

### wood veneer

- all wood veneer is mounted onto 3/4" mdf, unless otherwise noted
- all wood veneer finished panels are edgebanded with matching material.
- all wood veneer has a clear finish
- all edges that are not visible will be edgebanded or sealed, depending on location of edge
- 4 standard veneers: straight grain fir, quarter sawn oak, walnut and maple
- premium veneers: aniline dyed, teak, vertical caramelized bamboo

For full laminate selection go to website or [click here>>](#)



For full veneer selection go to website or [click here>>](#)

# THE BOX GUIDE



## LOWER BOX

- bottom, top and sides will be 3/4" pre finished maple construction
- applied backs will be 1/2" pre finished maple
- door boxes greater than 21" will have 2 doors
- all high quality BLUM hardware

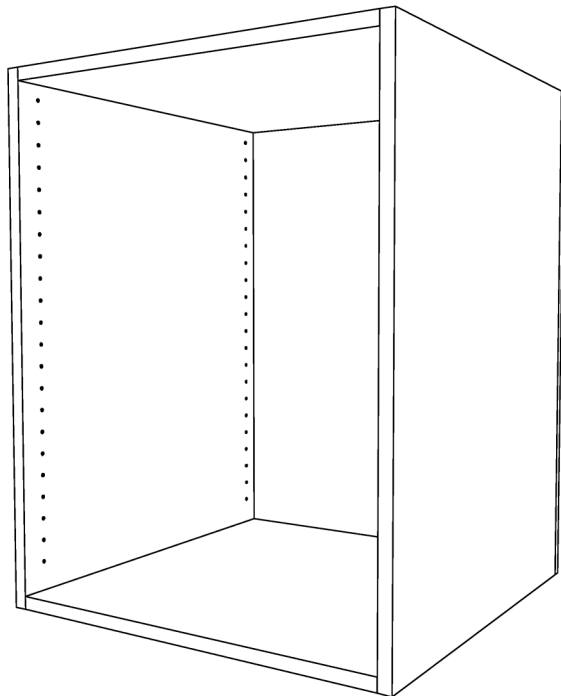

## dimensions

widths : 12" 15" 18" 21" 24" 27" 30" 33" 36" 40"

depths (A) : 12" 18" 24"

box heights (B) : 28 1/2" 30 1/2"

toekick height (C) : see toekick options below

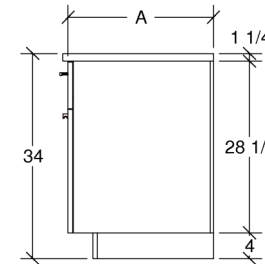

ADA compliant

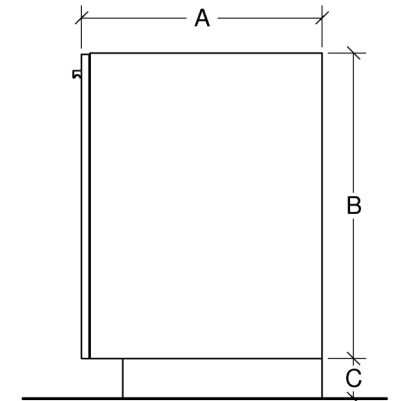

## toekick options

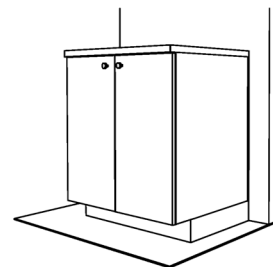

standard toekick

(C) = 4"

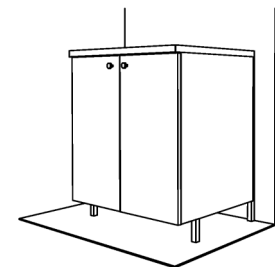

metal leg

(C) = 4" or 6"

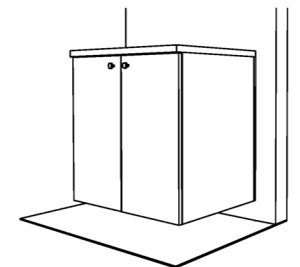

wall hung

(C) = varies

# THE BOX GUIDE



## LOWER BOX : options

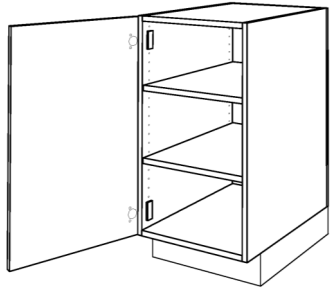

door box  
with adjustable shelves

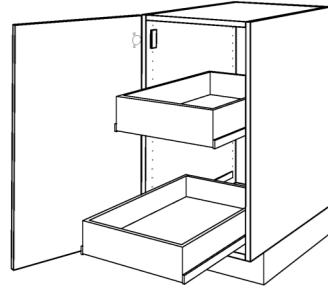

door box  
with pullout trays

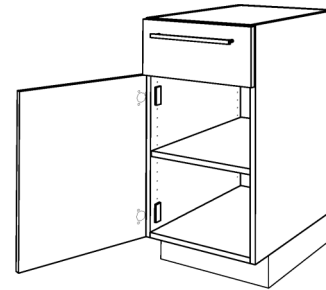

door + drawer box  
with adjustable shelves

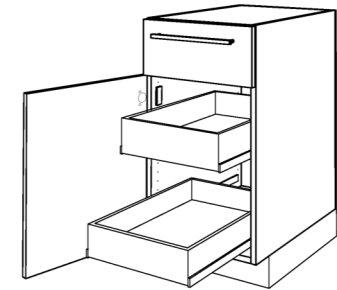

door + drawer box  
with pullout trays



2 drawers

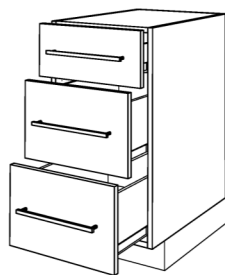

3 drawers

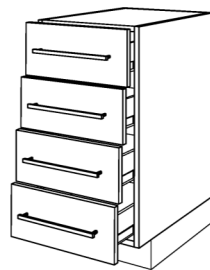

4 drawers

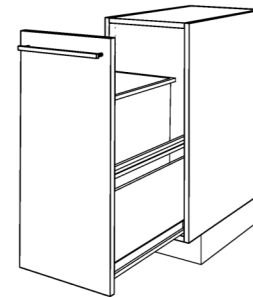

single 50 qt. bucket  
trash pullout system  
cabinet size:  
15" wide x 24" deep

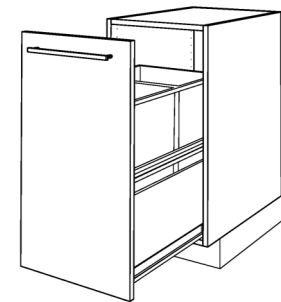

double 50 qt. bucket  
trash pullout system  
cabinet size:  
18" wide x 24" deep

# THE BOX GUIDE



## LOWER BOX : options

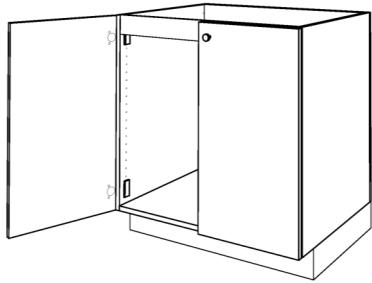

sink box

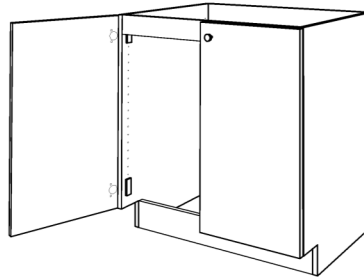

ADA sink box  
removable toekick

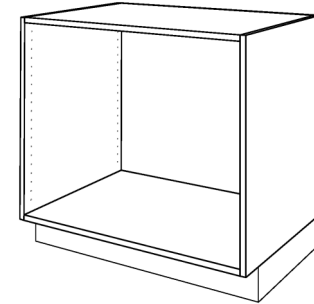

appliance ready boxes

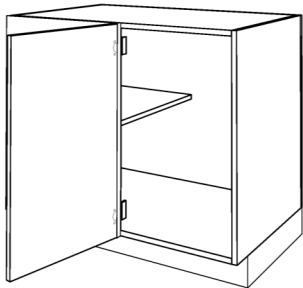

blind corner box  
door widths (A):  
15" 18" 21" 24"

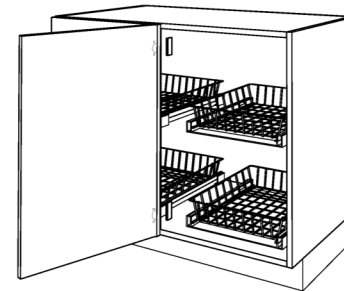
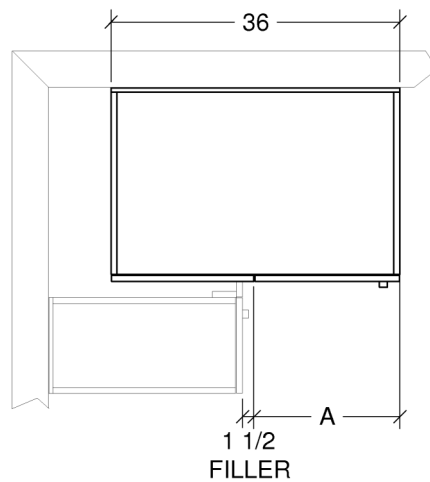

Hafele Magic Corner II  
cabinet size:  
42" wide x 24" deep

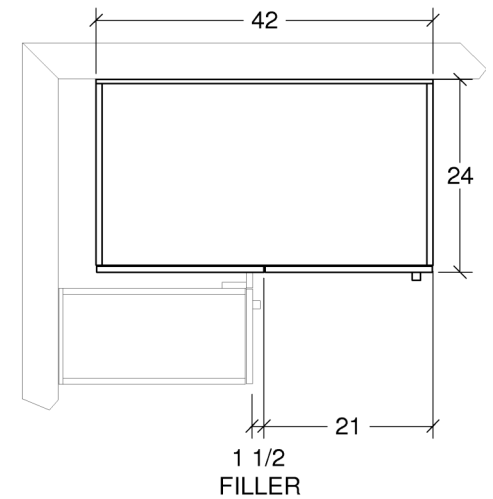

# THE BOX GUIDE



## PANTRY BOX

- bottom, top and sides will be 3/4" pre finished maple construction
- applied backs will be 1/2" pre finished maple
- door boxes greater than 21" will have 2 doors
- all high quality BLUM hardware

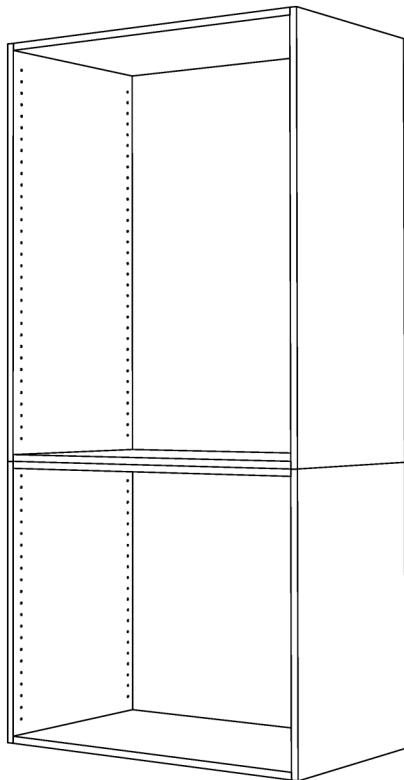

### dimensions

widths : 12" 15" 18" 21" 24" 27" 30" 33" 36" 40"

depths (A) : 12" 18" 24"

box heights (B) : 76" 80"

toekick height (C) : see toekick options below

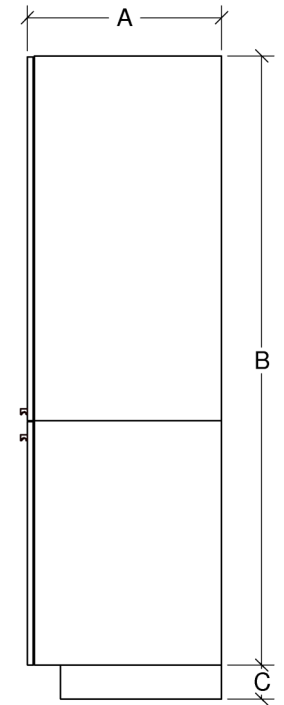

### toekick options

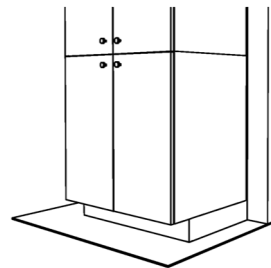

standard toekick

(C) = 4"

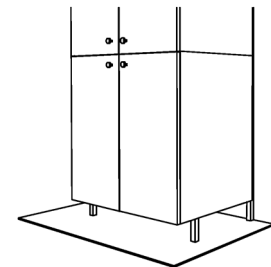

metal leg

(C) = 4" or 6"

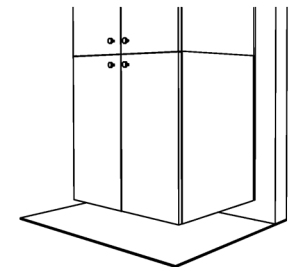

wall hung

(C) = varies



# THE BOX GUIDE



## PANTRY BOX : top box options

---

adjustable shelves

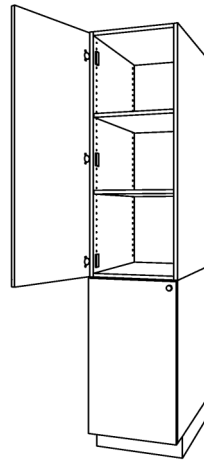

pull out trays

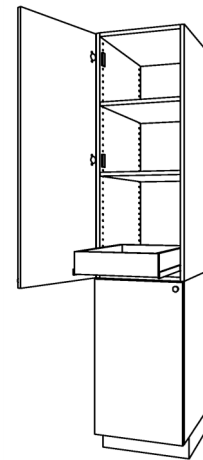

## PANTRY BOX : lower box options

---

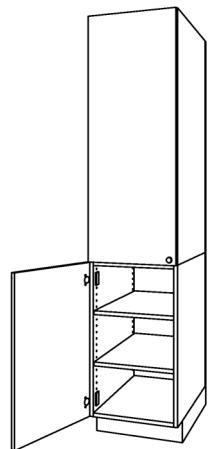

adjustable shelves

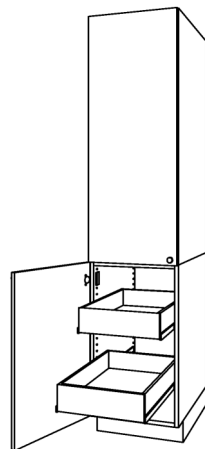

pull out trays

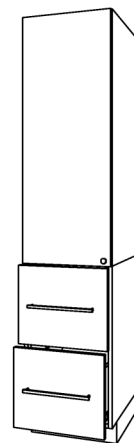

2 drawers

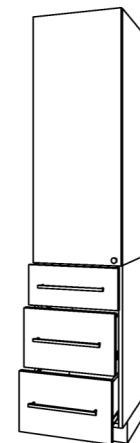

3 drawers

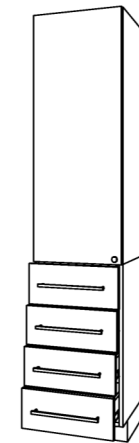

4 drawers

# THE BOX GUIDE



## UPPER BOX WITH INSET DOORS

- bottom, top and sides will be 3/4" construction
- wood veneer of choice
- 2 bay minimum for 15" and 18" modules
- Add-A-Bay option allows you to add additional bays up to 8' long
- all high quality BLUM hardware

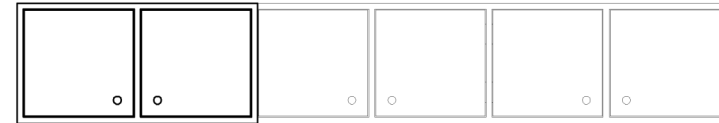

module sizes:  
15" 18" 20" 24"

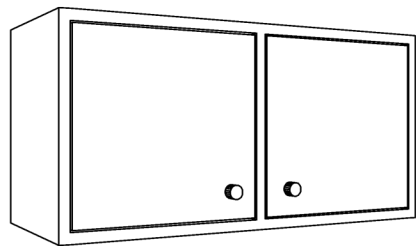

side hinged doors

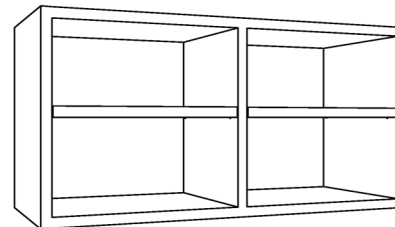

shelves

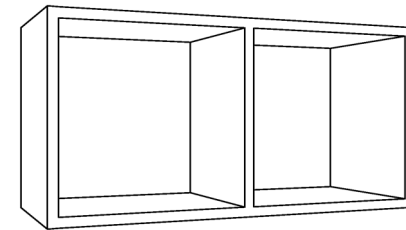

open

# THE BOX GUIDE



## UPPER BOX WITH OVERLAY DOORS

- bottom, top and sides will be 3/4" pre finished maple.
- applied backs will be 1/2" pre finished maple.
- 2 bay minimum for 15" and 18" modules
- Add-A-Bay option allows you to add additional bays up to 8' long
- all high quality BLUM hardware



module sizes:  
15" 18" 20" 24"

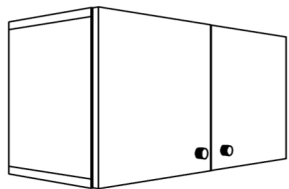

side hinged doors

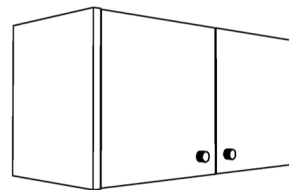

applied end panel

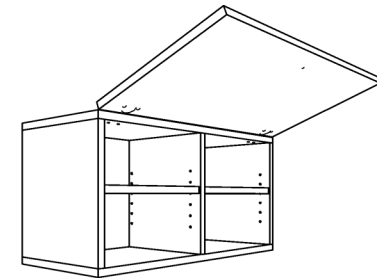

flip up doors

# THE BOX GUIDE



## 30" and 36" UPPER BOX WITH OVERLAY DOORS

- bottom, top and sides will be 3/4" pre finished maple
- applied backs will be 1/2" pre finished maple
- all high quality BLUM hardware

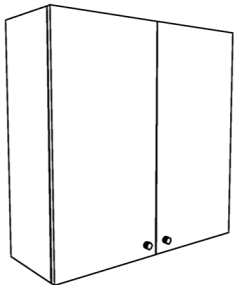
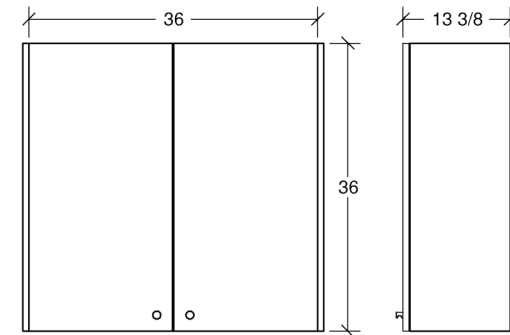
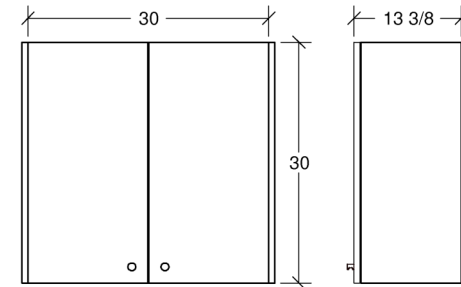

side hinged doors

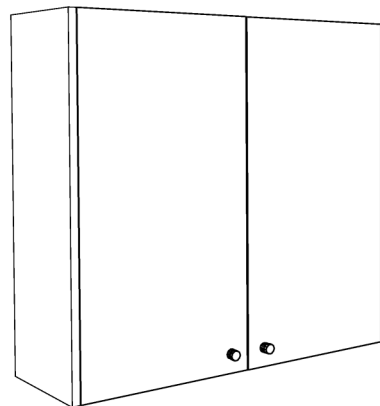

applied end panels

# THE BOX GUIDE



## DRAWER BOXES AND PULLOUT TRAYS

- drawer boxes and pullout trays are constructed using solid 1/2" maple with dovetail construction
- drawers and pullout trays will have soft close and full extension concealed drawer glides
- all interior pullout trays have a height of 4"
- Interior drawer box heights are 4", 8" and 10" and will be determined by the style of cabinet
- all high quality BLUM hardware

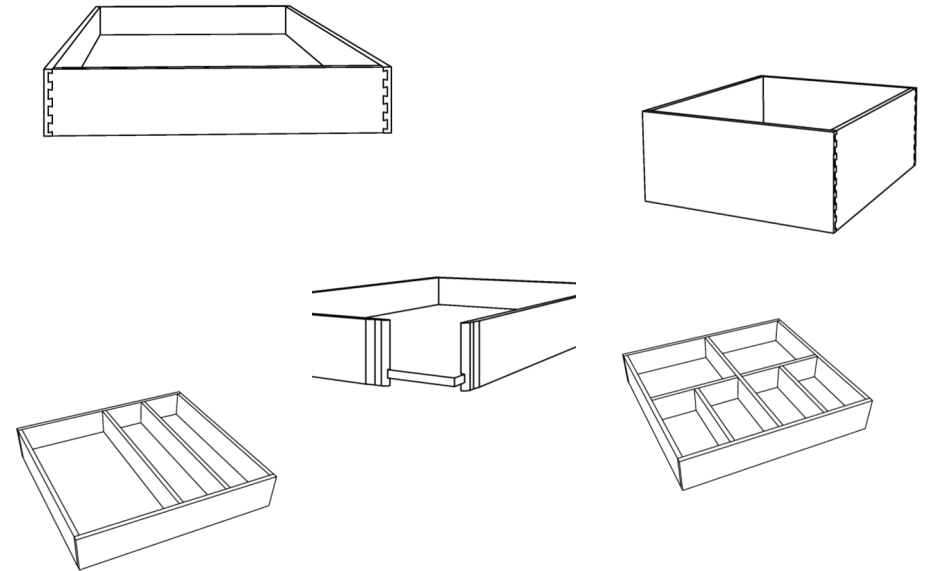

## ADJUSTABLE SHELVES

- 3/4" prefinished maple plywood
- edgebanded on front edge

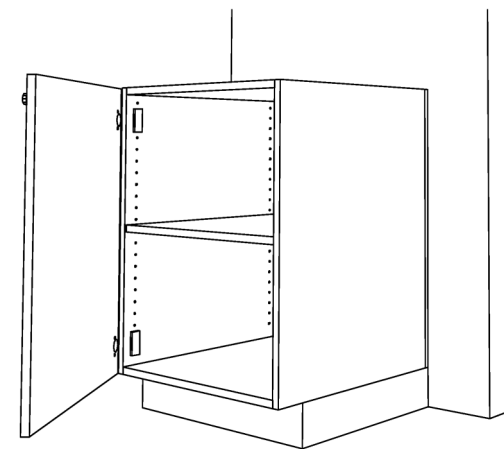
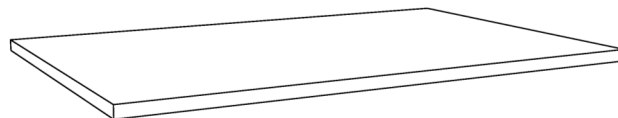

# THE BOX GUIDE



## APPLIED END / SIDE PANELS

- 3/4" multi-ply
- available in all materials



**lower  
side panels**

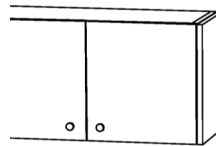

**upper  
side panels**

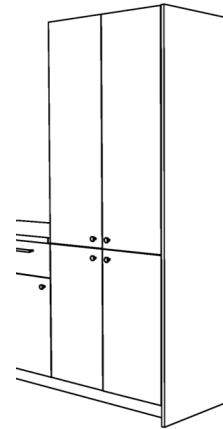

**pantry  
side panels**

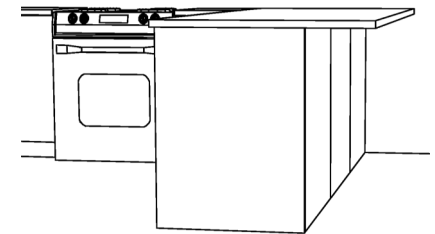

**island and peninsula  
side panels**

---

## FILLERS / TOEKICKS / MISC

- fillers and toekicks can be specified to match the cabinetry; or can be ordered in contrasting materials
- fillers\* will be cut in 2" widths x 8' long
- toekicks\* will be cut in 5" widths x 8' long

\*can be trimmed and/or scribed at time of installation

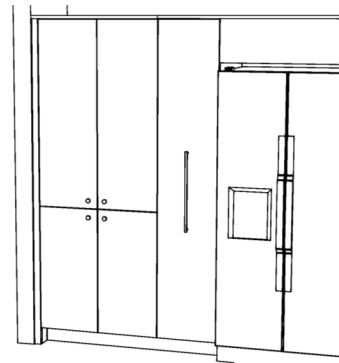

# THE BOX GUIDE



## ACCESSORIES

### cutlery / utensil inserts

---

- 1/2" solid maple construction
- integrated into drawer box

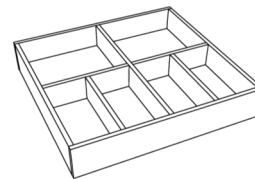

drawer dividers

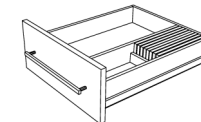
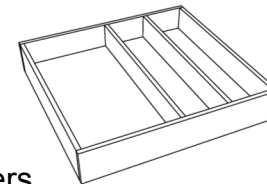

knife block insert

### lighting

---

- undercabinet puck lighting
- 2 3/8" diameter
- 50 watt halogen or LED
- surface mounted or recessed
- metal casing: black ; white ; satin nickel



### handles and knobs

---



stainless steel handles

6" 12" 18"



satin nickel door knobs

3/4" dia x 1" long